

## REPLACING THE FOIL FRAME & CUTTER

Replace the foil frame when you find you have to push harder on the shaver to get a close shave. It is also time to replace the foils if you experience skin irritation. Replacement time will depend on how often you use your shaver and how quickly your hair grows.

**Caution:** Never replace the cutters without replacing the foils as well.

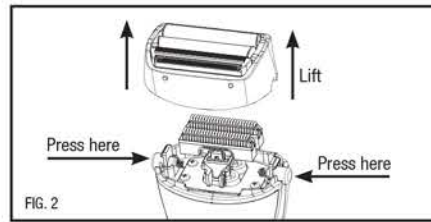

1. Remove the foil frame. (FIG. 2)

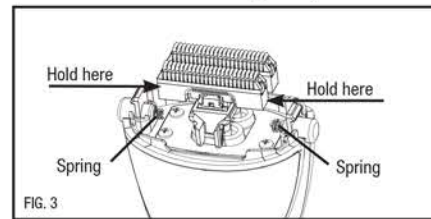

2. Push one side of the cutters to unlock it and take out. (FIG. 3) Be careful not to lose the small spring as it will be needed with the new cutters.

3. Hold the new cutters firmly on the sides and guide them gently into the inner cutter mount, one side at a time, until they lock into place. (FIG. 4)

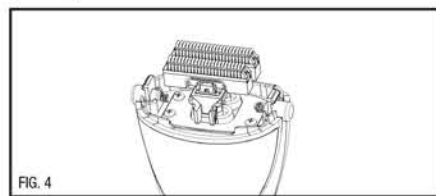

4. Press firmly until the cutter snaps into place.  
5. Replace the foil frame. (FIG. 5)

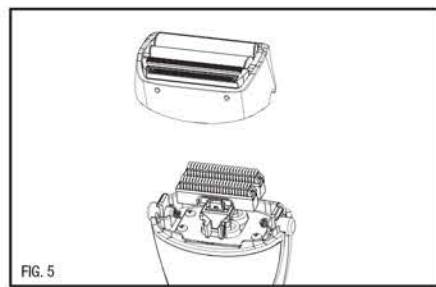

Congratulations on the purchase of your new Women's wet/dry shaver. For maximum satisfaction when using this quality product, please take a minute to read the following operating and care instructions. Thank you for choosing Conair, the #1 brand in personal care appliances.

## IMPORTANT SAFETY INSTRUCTIONS

When using an electrical appliance, basic precautions should always be taken, including the following:

### READ ALL INSTRUCTIONS BEFORE USING

### DANGER— To reduce the risk of death or serious injury from electrical shock:

1. Do not place or store shaver where the stand can fall or be pulled into a tub or sink. Do not place or drop charging stand into water or other liquid.
2. Except when charging, always unplug this appliance from the electrical outlet immediately after using.
3. Always turn this shaver off before cleaning.
4. Do not reach for an appliance that has fallen into water.

### WARNING— To reduce the risk of burns, fire, electrical shock, or injury to persons:

1. This appliance should not be used by, on, or near children or individuals with certain disabilities.

2. Use this appliance only for its intended use as described in this manual. Do not use attachments not recommended by the manufacturer.

3. Never operate this appliance if it has a damaged cord or plug, if it is not working properly, if it has been dropped or damaged, or if the stand has been dropped into water. Return the appliance to a service center for examination and repair.

4. Keep the cord away from heated surfaces.

5. Never drop or insert any object into any opening.

6. Do not use outdoors or operate where aerosol (spray) products are being used or where oxygen is being administered.

7. Do not use this appliance with damaged or broken foils, as injury may occur.

8. Always attach plug to appliance first, then to outlet. To disconnect turn all controls to off position before removing plug from outlet.

9. Don't let skin come into contact with moving blade.

10. Be sure voltage is correct before plugging in.

11. CAN ICES-3(B)

## SAVE THESE INSTRUCTIONS

### WARNING

1. Women whose skin is sensitive to cosmetics or easily irritated by shaving, or who suffer from a skin allergy, should test one section of the leg or arm before using the shaver.
2. The foils are thin and precisely fin-

## REPLACING THE POP-UP TRIMMER ASSEMBLY

Note: we do not recommend replacing the trimmer assembly yourself. Take or send the shaver to a Conair service center because this requires a special tool for replacement. For most users, these trimmers will stay sharp for as long as you own your shaver.

## BATTERY REMOVAL

1. Using a small Phillips head screwdriver, remove the screws at the front and bottom housing of the clipper.

2. Remove the PCB set and cut the battery out.

3. Bring the battery to the nearest collection centre for disposal or call the toll-free RBRC information line at 1-800-8-BATTERY. RBRC is a trademark of the The Rechargeable Battery Recycling Corporation. DO NOT throw the battery into the normal municipal waste system.

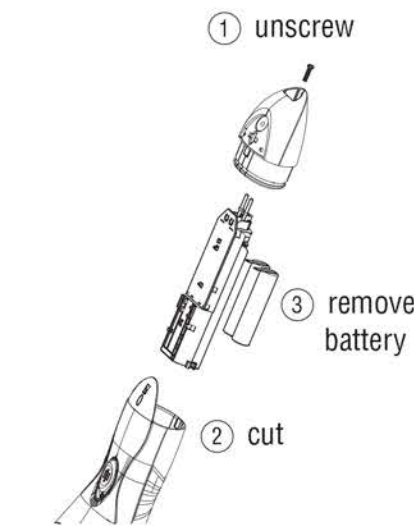

## BATTERY DISPOSAL

This appliance contains Nickel Metal Hydride batteries. To protect the environment this appliance and its batteries must be disposed of safely. At the end of its life, please take this appliance to a recycling center, where the internal rechargeable battery should be removed by a professional and recycled separately. For more information about the recycling of electrical and battery operated appliances please contact your local council office or your household waste disposal service. For specific enquiries regarding the replacement of batteries in this product please contact our Conair Customer Care Line.

CONTAINS NICKEL METAL HYDRIDE BATTERY. MUST BE COLLECTED, RECYCLED OR DISPOSED OF PROPERLY. DO NOT DISPOSE OF IN THE MUNICIPAL WASTE.



adapter). unplug the adapter when not in use.  
7. The adapter may become warm while charging---this is normal.

8. The battery life can be improved by periodically allowing the shaver to run until the motor stops, immediately turn off the switch and fully recharge.

### Rechargeable Model LWD8770RC

Congratulations! Smooth legs are just a shave away with your new women's wet/dry shaver. This shaver can be used with shaving cream, which provides a smoother, closer shave, or it can be used dry as a regular shaver. Because the shaver is fully submersible, you can conveniently shave in the shower or in the tub. And the shaver is easy to clean; simply rinse the cutting heads under a faucet, using warm or cold water (DO NOT USE HOT WATER. IT CAN DESTROY THE SHAVER'S SEALS.)

### CAUTION

Do not immerse any part of the charging stand or cord in water.

Do not try to plug the charging stand into an AC outlet while your hands are wet.

The outer foils and inner blades are delicate and must be handled very carefully.

### BEFORE SHAVING

1. Before wet shaving, you may wish to prepare your legs and underarms with shaving cream or soap. If a soapy lather is applied to the skin, the shaver will glide smoothly over the skin and clean away oil residue while at the same time removing hair. **Caution: DO NOT use shaving gels, as these products can clog your shaver foils.**

too hard and therefore not get a satisfactory shave. You must press gently so the hair can get into the holes of the foil pressing too hard makes the hair flat. Please be patient; use your shaver 10 to 12 times before you judge its performance.

### CHARGING: THE LWD8770RC

When charging the appliance, the LED charging light will show red. Although there is no risk of over charging, it is advisable to unplug the charging stand after a maximum of 24 hours. This will help prolong the battery life. The foils are extremely thin and precisely crafted. Don't push on the foils when inserting the shaver into the charging stand. For extra protection, keep the blade guard on while handling the unit in the charging stand as well as when not in use.

1. Before using for the first time, the appliance should be fully charged continuously for 16 hours. Maximum battery capacity will only be reached after 3 charging and discharging cycles.

2. While holding the charging stand with one hand, plug the shaver firmly into the charging stand with the other hand. Make sure the shaver is completely inserted. The charging light indicator will go on when the shaver is properly inserted into the base.

3. A full charge will supply enough power for approximately 30 minutes of use.

4. Place the appliance into the charging stand.

5. Ensure the appliance is switched off.

6. Plug the adapter into any wall outlet (at the voltage listed on the label affixed to the



## LIMITED ONE YEAR WARRANTY

Conair will repair or replace (at our option) your unit free of charge for 12 months from the date of purchase if the appliance is defective in workmanship or materials.

To obtain service under this warranty, return the defective product to the service center listed below that is nearest you, together with your purchase receipt and \$7.50 for postage and handling. California residents need only provide proof of purchase and should call 1-800-366-0937 for shipping instructions. In the absence of a purchase receipt, the warranty period shall be 12 months from the date of manufacture.

**ANY IMPLIED WARRANTIES, OBLIGATIONS, OR LIABILITIES, INCLUDING BUT NOT LIMITED TO THE IMPLIED WARRANTY OF MERCHANTABILITY AND FITNESS FOR A PARTICULAR PURPOSE, SHALL BE LIMITED IN DURATION TO THE 12 MONTH DURATION OF THIS WRITTEN, LIMITED WARRANTY.** Some states do not allow limitations on how long an implied warranty lasts, so the above limitations may not apply to you.

**IN NO EVENT SHALL CONAIR BE LIABLE FOR ANY SPECIAL, INCIDENTAL, OR CONSEQUENTIAL DAMAGES FOR BREACH OF THIS OR ANY OTHER WARRANTY, EXPRESS OR IMPLIED, WHATSOEVER.** Some states do not allow the exclusion or limitation of special, incidental, or consequential damages, so the above limitation may not apply to you.

This warranty gives you specific legal rights, and you may also have other rights, which vary from state to state.

Please register this product at:  
[www.conair.com/registration](http://www.conair.com/registration)

### SERVICE CENTRE:

Conair Consumer Products ULC  
100 Conair Parkway, Woodbridge, Ontario, L4H 0L2.

©2020 Conair Consumer Products ULC  
For information on any Conair product call 1-855-926-6247 or visit us on the web at: [www.conaircanada.ca](http://www.conaircanada.ca).  
Consumer Call Centre E-mail: [Consumer\\_Canada@Conair.com](mailto:Consumer_Canada@Conair.com)

19CNO35010

IB-16632

true glow body

Wet/Dry Rechargeable Shaver



## Have a Question?

Please do not return this product to the retailer.

## Call Us First!

Our customer service and product experts are ready to answer ALL your questions.

Please call our TOLL-FREE customer service number at:

1-855-926-6247

or visit us online at

[www.conaircanada.ca](http://www.conaircanada.ca)

Instructions for Care and Use

MODEL LWD8770RC

## HOW TO CLEAN YOUR SHAVER

1. Make sure unit is in the "OFF" position before cleaning your shaver.
2. Hold shaver head and lift up from the back, (FIG.1) then press foil frame release buttons on each side and lift up (the cutter is now in view). Be careful not to push on the foils. They are delicate and can easily be damaged.

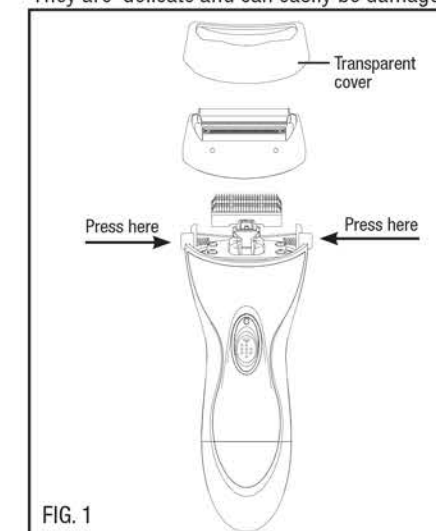

FIG. 1

3. Rinse the shaver cutter and foil frame under running water or in a sink. (You can use the cleaning brush which is included.) Do not use hot water. Use only warm or cold water.

4. After wet cleaning, allow the foil frame and cutters to air-dry before closing foil frame and shaver head. Replace shaver head back onto the shaver until it clicks into place. Wipe the surface of the main unit with a dry towel.

Do not dry the foil area. Let the shaving head air-dry. Once the shaving head is dry, replace the plastic protection cap.

5. The cutter can also be cleaned with the cleaning brush provided.

6. If the body of the shaver becomes dirty, wipe off with a damp cloth and mild detergent or soap. Never use thinners, other solvents, or any harsh cleaners.

## CAUTION

1. When shaking off excess water, hold the main unit firmly to prevent releasing the head assembly or dropping the unit.

2. Do not use a dryer or heater to dry the shaver. This may result in malfunction or damage to the shaver.

**NOTE:** Never pull on the charging stand cord. Never twist or wrap the cord around the charging stand.

One in the front and the second in the back. These cut longer hair to stubble length allowing the foil shaver to perform more effectively. The shaver also has a bikini pop-up trimmer for your complete shaving needs.

7. When you finish shaving, turn the shaver off.

8. To trim the bikini area, use the handy pop-up feature to easily see what you are trimming.

Important: After several uses, you will be able to determine the optimum shaving method for your legs and bikini area.

### SHAVING YOUR UNDERARMS

1. Prepare your underarms for wet or dry shaving. (Be sure that your skin is clean and free of deodorant).

2. Turn the shaver on.

3. Lift your arm until the skin under the arm stretches slightly.

4. Use the trimmer portion first to remove any long hair, stroking trimmer against the direction of hair growth.

5. Hold the shaver so that it is in full contact with your skin, and shave with gentle strokes.

6. It is important to press lightly. Pressing too hard may lead to skin irritation.

7. When finished shaving, turn the shaver off. Important: After several uses, you will be able to determine the optimum shaving method for your underarms.

2. When dry shaving, be certain that your skin is clean. If you have sensitive skin, you may want to apply talcum powder before and after you shave.

3. Clean your shaver after each use. This will insure the best performance. (Please refer to "How to Clean Your Shaver" section for further instructions.)

4. Although the shaver is waterproof, do not submerge it under water for extended periods of time.

### INSTRUCTIONS FOR USE:

1. Remove the plastic protection cap.
2. Slide the main switch up to the ON position.
3. After each shave, switch the unit off, clean, and replace the protective cap.
4. Put the unit back on the charging stand for storage and/or recharging.

### SHAVING YOUR LEGS/BIKINI AREA

NOTE: Pushing the shaver against the skin too hard will not allow the hairs to enter the foils and be cut. Experience will show just the right pressing to use to maximize performance.

1. Prepare your legs for wet or dry shaving.
2. Turn shaver on.
3. Shave with smooth, steady strokes up and down your skin.
4. Keep the full shaving head in contact with your skin.
5. For best results, shave against the direction of hair growth.
6. Your shaver has two full size trimmers.